

MODEL 2833

PRODUCT FEATURES

3 HP Grinder Pumps - Dual Seal

60 Hz

visit our web site:
zoellerpumps.com

APPLICATIONS

- Low pressure sewer systems
- High head sewage systems
- Domestic, commercial, wastewater and sewage

MATERIAL FEATURES

PUMP:

- Hardened 440 stainless steel (Rockwell 55-60) shredding ring and cutter
- 2" NPT discharge
- Both ends of the pump are protected by tandem carbon / ceramic and silicon carbide mechanical seal
- Thermal sensor is mounted directly on the windings in the three phase models for maximum temperature sensing (requires circuit in control panel to function)
- Moisture probes for leak detection (requires circuit in control panel to function)
- Cast iron ASTM A48 Class 30
- Attaching hardware - 304 stainless steel
- The cord seal is epoxy-potted for superior moisture resistance and anti-wicking
- Ductile iron impeller for superior quality and long life
- Optional: ☐ Trimmed impeller

MOTOR:

- 3 HP, 3450 RPM
- 3 Phase - 380 Volt
- Stator - Class F insulation and lead wires Nema B design
- Oil-filled motor for better cooling and lubrication
- Moisture probe for leak detection
- Housing - cast iron
- Power and sensor cable length - 30' (9 m)
- Ball bearings - upper and lower high carbon chromium steel

FEATURES

1. 30' (9 m) power cord.
2. Heavy-duty cord connections.
3. The cord seal is epoxy-potted for superior moisture resistance and anti-wicking.
4. Stainless steel lifting bail.
5. Oil-filled motor housing ensures uniform heat distribution, lubricates bearings, and conducts heat for cooler running.
6. Tandem seals. Carbon/rotating, ceramic/stationary upper, silicon carbide/silicon carbide lower, Buna-N elastomers.
7. Upper and lower high carbon chromium steel ball bearings.
8. Stainless steel shaft and hardware resist corrosion.
9. Moisture probes with upper and lower probes protect the motor from liquid entry.
10. Thermal sensor protection.
11. 30' (9 m) power and sensor cable.
12. Ductile Iron impeller design, fully balanced with integral pump-out vane to clear debris.
13. Stainless steel shredding ring and cutter hardened to Rockwell 55-60.
14. Concentric pump housing with centerline discharge reduces radial loading for longer bearing and shaft seal life.
15. 2" NPT vertical discharge.
16. Cast iron support legs enable the pump to be free-standing.
17. Cast iron ASTM A48 Class 30 strength.

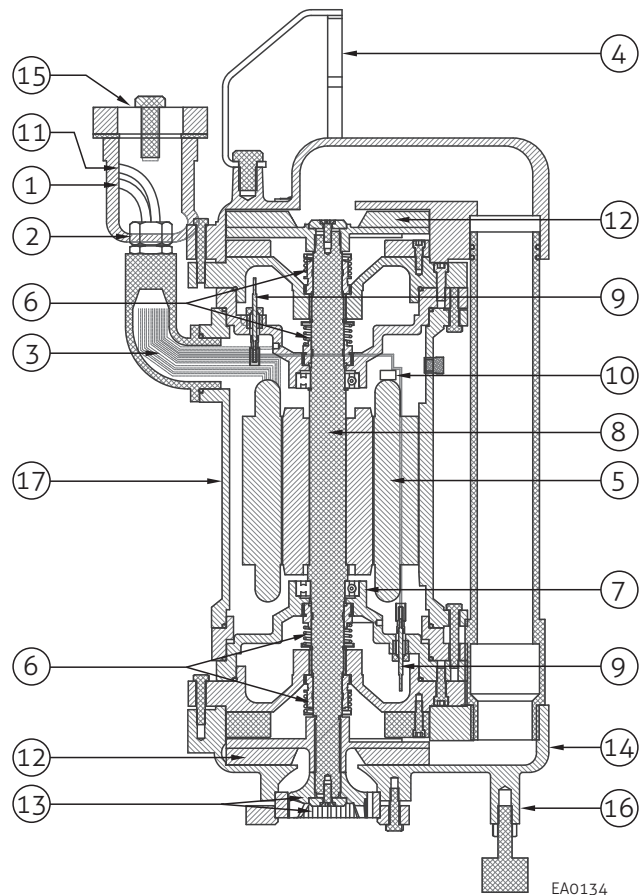

EA0134

MODEL 2833

TECHNICAL DATA

3 HP Grinder Pumps - Dual Seal

MODELS:	<input type="checkbox"/> 2833
PUMP NAME PLATE HORSEPOWER:	3
MAXIMUM KW INPUT:	9.5
STANDARD IMPELLER DIAMETER:	5.354" (136 mm)
DISCHARGE SIZE:	2" NPT

IMPELLER TYPE:	SEMI-OPEN	TANDEM SEALS:	STANDARD
CUTTER & PLATE:	440 C SS HARDENED TO ROCKWELL 55-60	MOTOR DESIGN LETTER:	NEMA B
PUMP NET WEIGHT:	213 lbs. (97 kg)	POWER CORD LENGTH: ft (m) (30' [9 m] STANDARD)	<input type="checkbox"/> 50' (15.2 m)
O RINGS:	BUNA-N	POWER CORD:	14 GAUGE STOW
MOTOR SHAFT:	SS410	STATOR & LEAD WIRES INSULATION:	CLASS F
RPM:	3450	MAXIMUM STATOR TEMPERATURE:	311 °F (155 °C)
MOTOR TYPE:	SUBMERSIBLE		

SHAFT SEAL CONSTRUCTION:	STANDARD	CARBON/CERAMIC UPPER SILICON CARBIDE/SILICON CARBIDE LOWER
	OPTIONAL UPPER	<input type="checkbox"/> CARBON /SILICON CARBIDE <input type="checkbox"/> SILICON CARBIDE/SILICON CARBIDE
	OPTIONAL LOWER	<input type="checkbox"/> CARBON /SILICON CARBIDE <input type="checkbox"/> SILICON CARBIDE/SILICON CARBIDE
STANDARD SENSING DEVICES*	MOTOR THERMAL SHUTOFF	THERMAL CUT-OUT
	MOISTURE DETECTION	MOISTURE SENSING PROBES
IMPELLER MATERIAL	2833	STANDARD DUCTILE IRON
IMPELLER TRIM:	<input type="checkbox"/> OPTIONAL	DESIGN POINT: ____ GPM @ ____' TDH, IMPELLER DIA. ____"
MAXIMUM WATER TEMPERATURE:		104 °F (40 °C) Continuous, 140 °F (60 °C) Intermittent

*Requires a circuit in control panel to function.

MODEL	HP	<input type="checkbox"/> 380V / 3 PH	
		FLA	LRA
2833	3	15	46

RESERVE POWERED DESIGN

For unusual conditions a reserve safety factor is engineered into the design of every Zoeller® pump.

MODEL 2833
PERFORMANCE CURVE
3 HP Grinder Pumps - Dual Seal

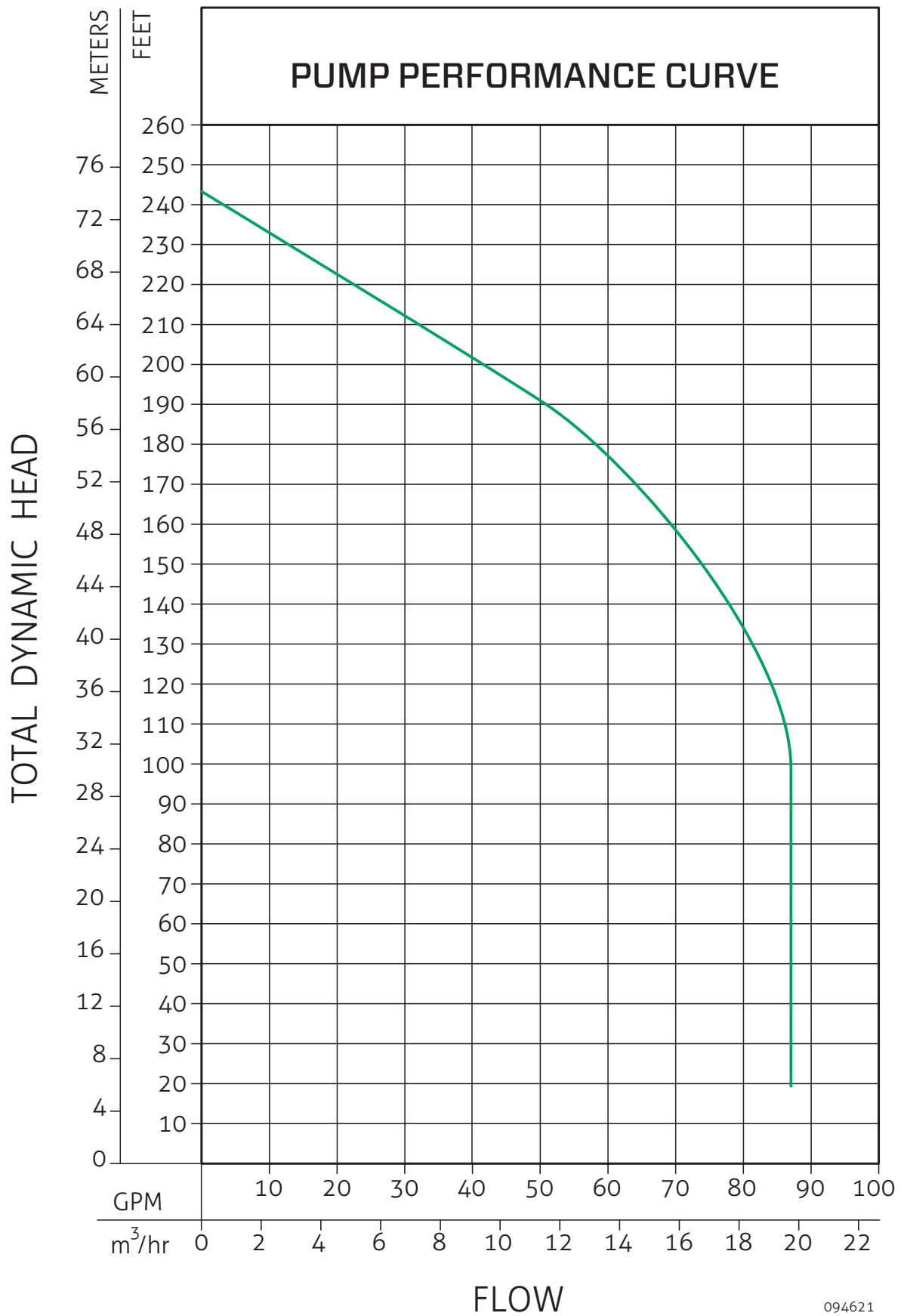

094621

MODEL 2833

DIMENSIONAL DRAWING

3 HP Grinder Pumps - Dual Seal

