

MOUNTING THE SWITCH

Warning: Do not install switch in direct line of incoming liquid.

- 1. Determine desired activation level and pumping range as shown in Figure A. Pumping range can be adjusted by moving the float stop up or down the rod.
- 2. Insert hose clamp through slots in mounting bracket as shown in Figure B.
- 3. Position hose clamp around discharge pipe with bracket gripping tabs against pipe. Cable should remain outside of hose clamp.
- 4. Tighten the hose clamp securely.
- 5. Secure pump cable and switch cable to discharge pipe as shown in Figure A.

Figure A

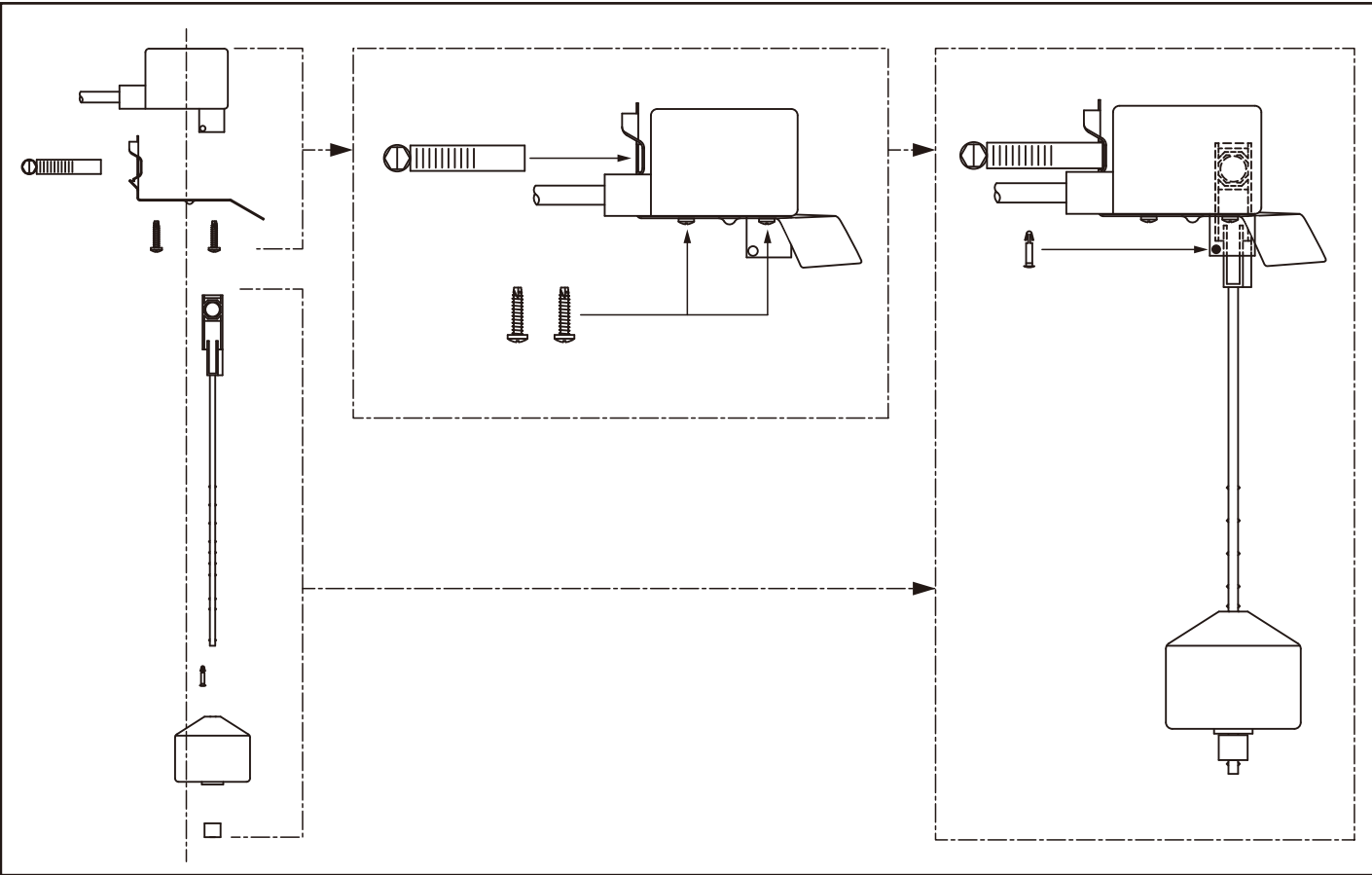
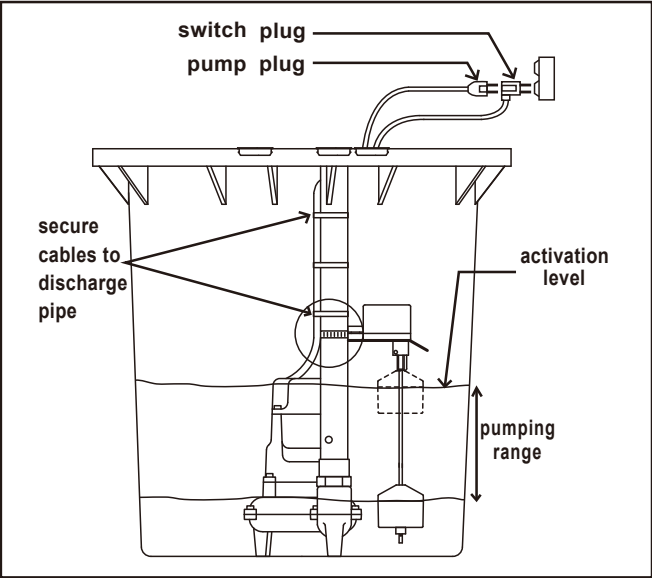

PIGGY-BACK PLUG INSTALL

- Electrical outlet must not be located in pump chamber.
- Electrical outlet voltage, piggy-back plug voltage, and pump voltage must match.

- 1. Follow steps 1 through 5 of "Mounting The Switch."
- 2. Insert the switch's piggy-back plug into outlet.
- 3. Plug pump into piggy-back plug as shown in Figure A.
- 4. Check installation. Allow system to cycle to ensure proper operation.

DIRECT WIRE INSTALL

- 1. Follow steps 1 through 5 of "Mounting The Switch."
- 2. Wire switch as shown below.
- 3. Check installation. Allow system to cycle to insure proper operation.

Figure B

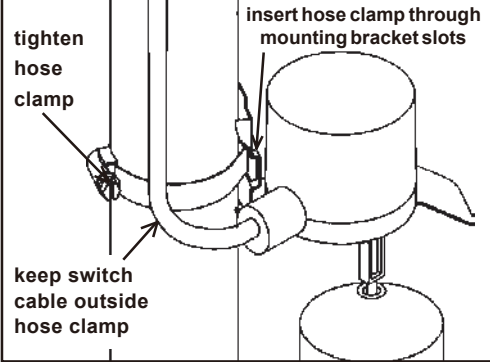
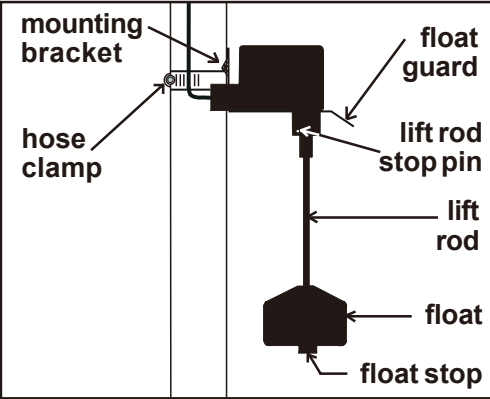

Figure C



Notice to Installer: Instructions must remain with installation.

Trusted. Tested. Tough.™

Product information presented here reflects conditions at time of publication. Consult factory regarding discrepancies or inconsistencies.



Visit our web site:
zoellerpumps.com

VERTICAL PUMP SWITCH
INSTALLATION INSTRUCTIONS

This mechanically activated pump switch is designed for direct control of pumps in non-potable water and sewage applications. It works well in applications with limited space such as: small sump chambers, effluent applications, and laundry trays, as well as in large tanks. The vertical pump switch is not sensitive to turbulence and is available for pump down applications only.

- Heavy-duty contacts.
- Adjustable pumping range of .75 to 6.5 inches (2 to 17 cm).
- Maximum operating temperature 125°F.

U.S. Patent No. 5,155,311
Canadian Patent No. 2,060,748



PREVENTATIVE MAINTENANCE

- Periodically inspect the product. Check that the cable has not become worn or that the housing has not been damaged so as to impair the protection of the product. Replace the product immediately if any damage is found or suspected.
- Periodically check to see that the float and rod are free to move and operate the switch.
- Use only Zoeller® replacement parts.

⚠ WARNING

ELECTRICAL SHOCK HAZARD

Disconnect power before installing or servicing this product. A qualified service person must install and service this product according to applicable electrical and plumbing codes.

⚠ WARNING

EXPLOSION OR FIRE HAZARD

Do not use this product with flammable liquids. Do not install in hazardous locations as defined by National Electrical Code, ANSI/NFPA 70.

Failure to follow these precautions could result in serious injury or death. Replace product immediately if switch cable becomes damaged or severed. Keep these instructions with warranty after installation. This product must be installed in accordance with National Electric Code, ANSI/NFPA 70 so as to prevent moisture from entering or accumulating within boxes, conduit bodies, fittings, float housing, or cable.

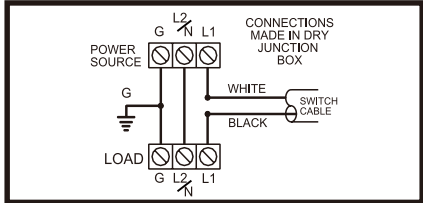

⚠ WARNING

In 230 VAC installations, one side of the line going to the load is always **HOT**. This condition exists if the switch is on or off. Install double pole disconnect on all 230 VAC circuits.

LIMITED WARRANTY

This product is warranted for one year from the date of purchase or 18 months from the date of manufacture, whichever occurs first. Subject to the conditions hereinafter set forth, the manufacturer will repair or replace to the original consumer, any portion of the product which proves defective due to defective materials or workmanship. To obtain warranty service, contact the dealer from whom the product was purchased. The manufacturer retains the sole right and option to determine whether to repair or replace defective equipment, parts or components. Damage due to conditions beyond the control of the manufacturer is not covered by this warranty.

THIS WARRANTY WILL NOT APPLY: (a) To defects or malfunctions resulting from failure to properly install, operate or maintain the unit in accordance with printed instructions provided; (b) to failures resulting from abuse, accident or negligence; (c) to normal maintenance services and the parts used in connection with such service; (d) to units which are not installed in accordance with normal applicable local codes, ordinances and good trade practices; and (e) if the unit is used for purposes other than for what it was designed and manufactured.

THE WARRANTY PROVIDED HEREIN IS IN LIEU OF ALL OTHER EXPRESS WARRANTIES, AND MAY NOT BE EXTENDED OR MODIFIED BY ANYONE. ANY IMPLIED WARRANTIES SHALL BE LIMITED TO THE PERIOD OF THE LIMITED WARRANTY AND THEREAFTER ALL SUCH IMPLIED WARRANTIES ARE DISCLAIMED AND EXCLUDED. THE MANUFACTURER SHALL NOT, UNDER ANY CIRCUMSTANCES, BE LIABLE FOR INCIDENTAL, CONSEQUENTIAL OR SPECIAL DAMAGES, SUCH AS, BUT NOT LIMITED TO, DAMAGE TO, OR LOSS OF, OTHER PROPERTY OR EQUIPMENT, LOSS OF PROFITS, INCONVENIENCE, OR OTHER INCIDENTAL OR CONSEQUENTIAL DAMAGES OF ANY TYPE OR NATURE. THE LIABILITY OF THE MANUFACTURER SHALL NOT EXCEED THE PRICE OF THE PRODUCT UPON WHICH SUCH LIABILITY IS BASED.

This warranty gives you specific legal rights, and you may have other rights which vary from country to country. Some countries do not allow limitations on duration of implied warranties or exclusion of incidental or consequential damages, so the above limitations may not apply to you.

In those instances where damages are incurred as a result of an alleged pump failure, the Homeowner must retain possession of the pump for investigation purposes.

安装开关

警告：请勿直接安装於入水口。

- 1. 确定所需的动作水位与抽水范围请参考图A。抽水范围可以经由杆子上的浮子移动上下来调整。
- 2. 在支撑托架上由狭缝插入软管铁箍，如图B所示。
- 3. 将软管箍在排水管上，托架紧箍著排水管。电线必须留在软管铁箍外。
- 4. 锁紧管夹。
- 5. 水泵电缆和开关的电缆连接著排水管，如图A所示。

图 A

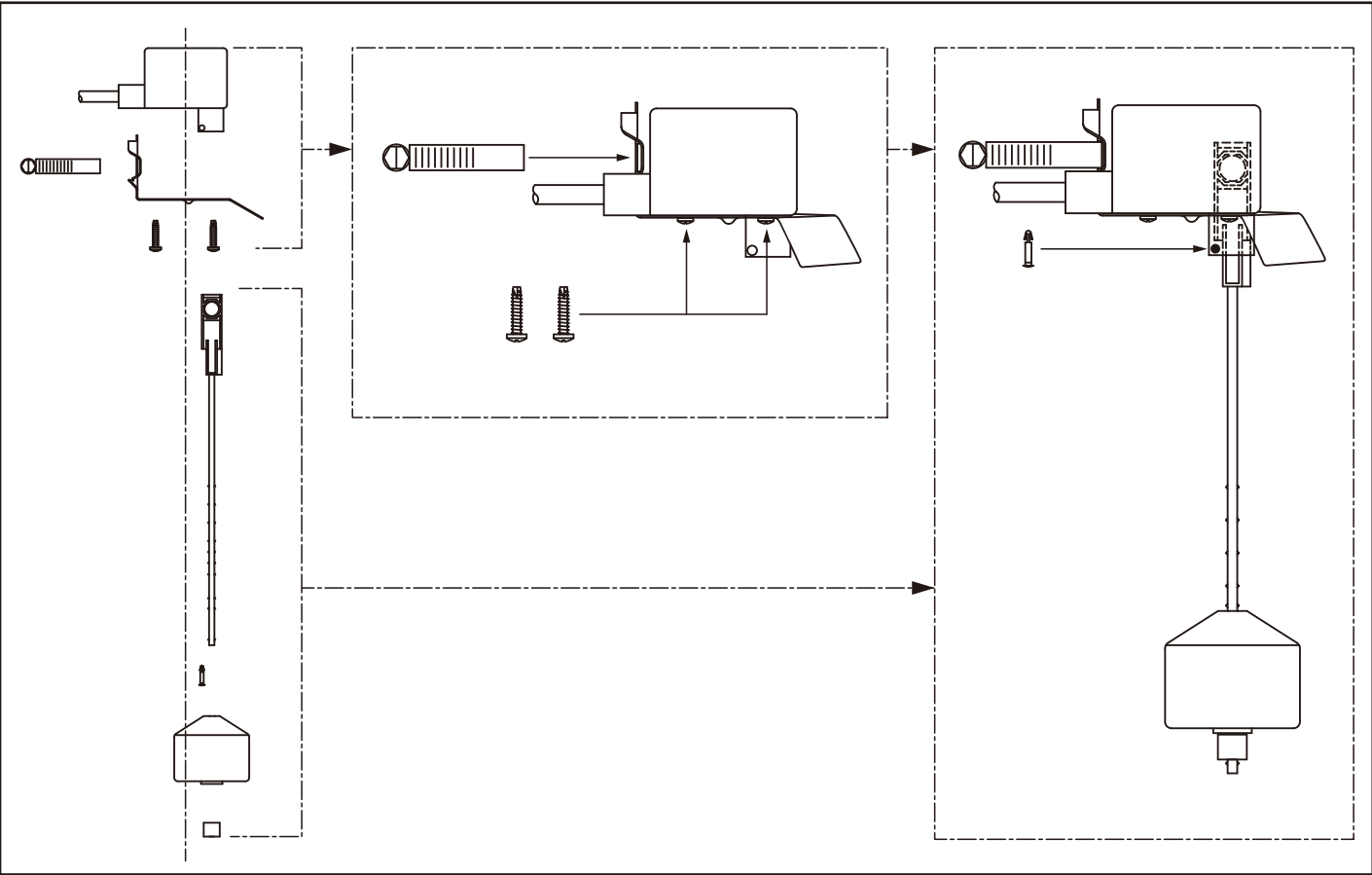
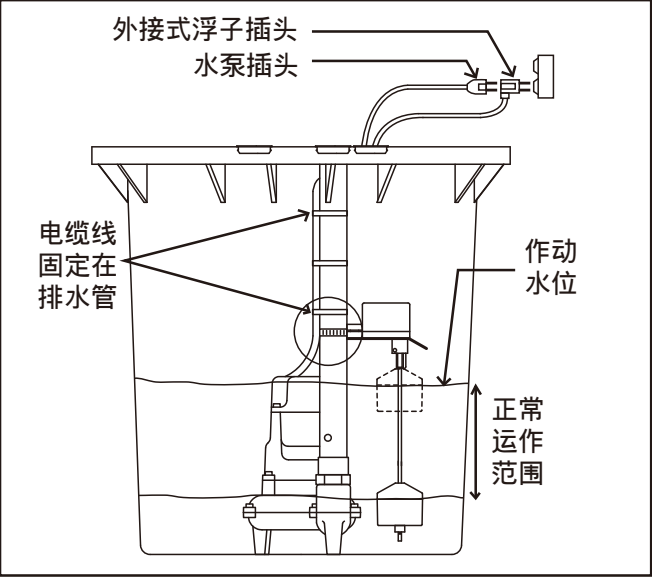

外接式浮子插头安装

- 电源插座不能安装在水泵槽内。
- 电源插座的电压、浮球开关电压和水泵电压必须一致。
- 1. 按照步骤1~5安装开关。
- 2. 将开关的外接式浮子插头插入电源插座。
- 3. 将泵浦插头插入外接式浮子插头，如图A所示。
- 4. 检查安装。让系统循环以确保正确的操作。

电线安装

- 1. 按照步骤1~5安装开关。
- 2. 电线开关，如下所示。
- 3. 检查安装。让系统循环以确保正确的操作。

图 B



图 C



安装前务必详读说明书

Trusted. Tested. Tough.™

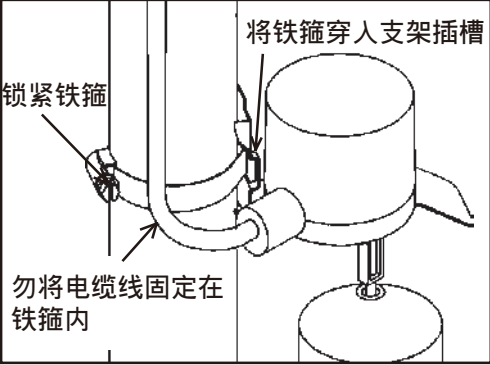
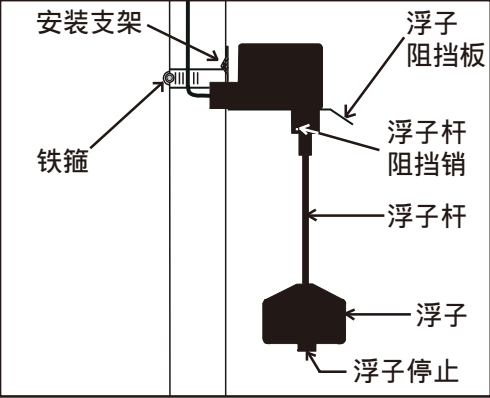
文件仅供参考
若有任何修改
恕不另行通知



zoellerpumps.com

外接垂直式浮子开关安装说明书

这是机械式启动水泵开关设计於直接控制泵在非饮用水和污水处理的应用。它在有限的空间的应用上有良好的工作特性内，如：小水池，污水应用和洗衣盘在大型桶子中也可使用。垂直式水泵开关无法感应湍流而且只用於水泵应用。

- 重负荷的接触器。
- 可调整抽水范围为20~170mm。
- 最高环境温度125°F。

U.S. Patent No. 5,155,311
Canadian Patent No. 2,060,748



预防性维护

- 定期检查的产品。检查电缆是否老旧损坏或水泵外壳是否已经损坏无法保护水泵。如果发现或怀疑有任何损坏，立即更换产品。
- 定期检查地看到，操作开关时，浮子和浮子杆可以自由移动。
- 更换时，只能使用原厂零件。

警告



电击的危险

安装或维修前请先切断电源。合格的维修人员必须在服务安装产品时依照合适的电机和配管法规。

警告



爆炸或火灾危险

请勿将本产品与易燃液体一起使用。不要安装在危险场所，须符合国家电器法规。

未能遵守这些预防措施，可能会导致严重的人身伤害或死亡。立即更换产品如果开关的电缆损坏或断裂。安装後妥善保存说明书。请依照国家电器规范安装本产品，防止水分由外壳，水管件，配件，浮球，或电缆进入或聚积。

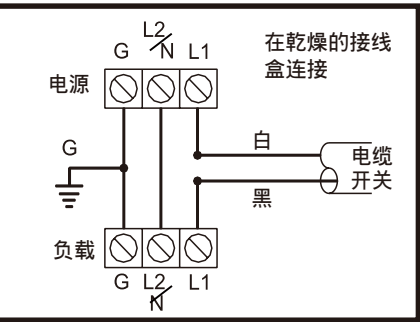

警告



在230伏交流电的安装，负载线总是通电中的状态。不论浮子开关是通路或断路，一个侧边的负载总是热的。安装双极断路器在230交流电。

所有回路上，确保电缆连接在乾燥的接线箱或是其他防水密封，密封件包括导体和电缆外皮。

如果不这样做，可能会导致触电的危险或水沿著电缆和进入开关。没遵照防范的预防可能影响开关的效能。

保固说明

本产品的保固为自购买日起算的一年、或从工厂制造日期起算的18个月，以先到期者为准。若能证明产品的缺陷是由材料或制造过程造成，本公司将负责维修或更换。本公司保留决定是否维修或更换产品、零件或配件的权利。维修或更换期间买方所产生的费用或损失不在保固范围内。本公司无法控制的损坏不在保固范围内。

保固不适用于：

- (1) 未依照说明书安装、操作或维护所造成的故障或损坏。
- (2) 不当操作、意外或疏忽所造成故障或损坏。
- (3) 加装不属于本产品的零、配件。

(4) 未依照当地法规进行安装所造成的危害。

(5) 将产品用在非原本设计的用途上所造成的损坏。

保固零、配件的退回：在本保固之下任何修理或更换需送回本公司或其他本公司所指定的维修服务点，运费需自付。在任何情况下本公司不负担其他责任，包含资产或设备的损坏、利润损失、等.....

本公司的责任不超过产品的实售价格。

上述为本产品唯一的保固说明，任何人的修改或另做承诺皆为无效。

在因涉嫌产品故障而招致损害的情况下，财产拥有人必须保留该产品以供调查之用。